

Portion 70 of the Farm Doornkloof 391 – JR

Public Notice

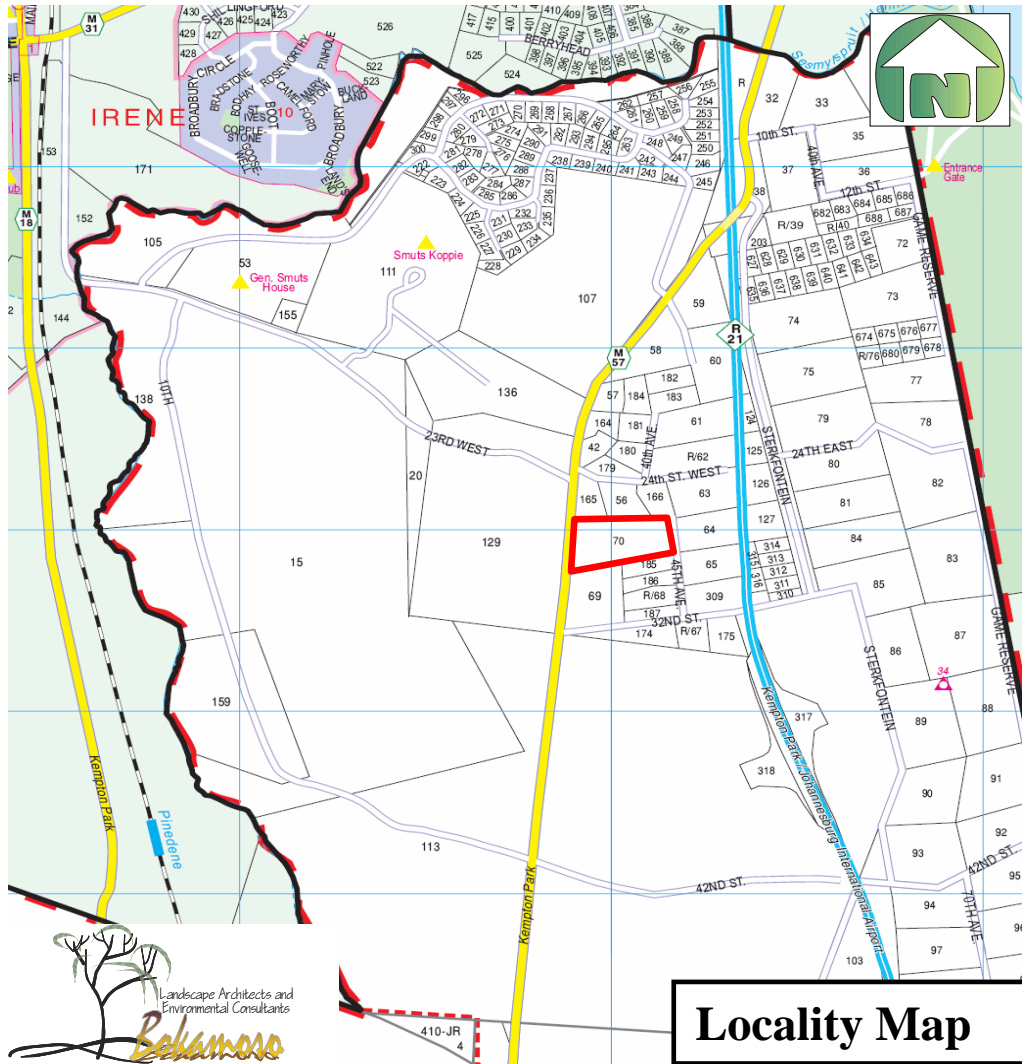

Locality Map



Please do not hesitate to contact us if there are any questions in connection with the above-mentioned development.

Contact Person: Philip Beukes
 Fax (012) 460 7079

Tel (012) 346 3810
 E-mail lizelleg@mweb.co.za

Notice is given of an application for Environmental authorization that was submitted to the Gauteng Department of Agriculture, Conservation and Environment, in terms of regulation no. R385 published in the Government Notice no. 28753 of 21 April 2006 of the National Environment Management Act, 1998 (Act No. 107 of 1998) governing Scoping procedures (Notice 1 and 2 – Governing Notice R386 & R387) for the following activity:

Name of project: Portion 70 of the Farm Doornkloof 391 JR

Project description: 2Ha Portion – Commercial and quasi industrial rights including offices and retail. Maximum 3 Storeys. Coverage Max 60 % (FSR 0,6).
 9Ha Portion – Commercial and quasi Industrial rights, maximum 2 storeys. Coverage Max 60% (FSR 0,6).

The application was submitted for the following activities in terms of the Government Notice R. 386 & R. 387, 21 April 2006:

- Indicate the number and date of the relevant Government Notice: Activity No (s) (in terms of the relevant notice) :Describe each listed activity:R.386, 21 April 2006Activity 1jAgri-Industrial purposes, outside areas with an existing land use zoning for industrial purposes, that cover an area of 1000 square meters or moreR.386, 21 April 2006Activity 1kThe bulk transportation of sewage & water, including storm water in pipelines with (i) an internal diameter of 0,36 meters or more (ii) a peak throughout of 120 liters per second or moreR.386, 21 April 2006Activity 1lThe transmission & distribution of electricity above ground with a capacity of more than 33 kilovolts & less than 120 kilovolts.R.386, 21 April 2006Activity 1n The off-stream storage of water, including dams & reservoirs, with a capacity of 50 000 cubic meters or more, unless such storage falls within the ambit of the activity listed in item 6 of Government Notice No R. 387 of 2006R.386, 21 April 2006Activity 1vAdvertisements as defined in classes 1(a), 1(b), 1(c), 3(a), 3(b), 3(l) of the South African Manual for Outdoor Advertising ControlR.386, 21 April 2006Activity 15 The construction of a road that is wider than 4 meters or that has a reserve wider than 6 meters, excluding roads that fall within the ambit of another listed activity or which are access roads or less than 30 meters longR.386, 21 April 2006Activity 16bThe transformation of undeveloped, vacant or derelict land to – residential, mixed, retail, commercial, industrial or institutional use where such development does not constitute infill and where the total area to be transformed is bigger than 1 hectare.R.386, 21 April 2006Activity 17 Phased activities where any one phase of the activity may be below a threshold specified in the Schedule but where a combination of the phases, including expansions or extensions, will exceed a specified threshold

Extent: The study area is approximately 11.1ha in extent.

Date: 18 January 2008

Ref No.: Gaut 002/07-08/N0746

Name of the proponent: Cream Magenta 132 (Pty) Ltd

Location: The site is situated directly east of the M57 and west of 45th Street, west of the R21, the site is approximately 1km south of the St. George Hotel and Conference Center, on Portion 70 of the Farm Doornkloof 391 JR

NOTE: In order to be ensure that you are registered as an interested and/or affected party, please submit your name, contact information and interest in the matter to Bokamoso Environmental Consultants (contact person & contact details are given to the left) on or before 19 February 2008.